

N

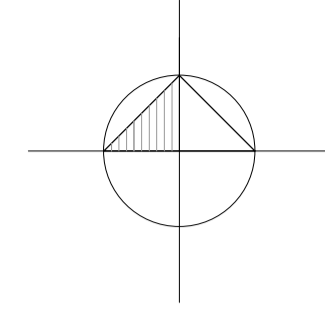

Figured dimensions to be followed in preference to those scaled from drawing.
All dimensions to be verified on site by the contractors and such dimensions to be their responsibility.
Drawing omissions and errors to be reported immediately to the architect.

LEGEND

- Hatch denotes proposed fire evacuation muster location points.
- dashed line denotes approximate route of proposed new cycle path. Note: this is in addition to the cycle routes approved under current planning consents.

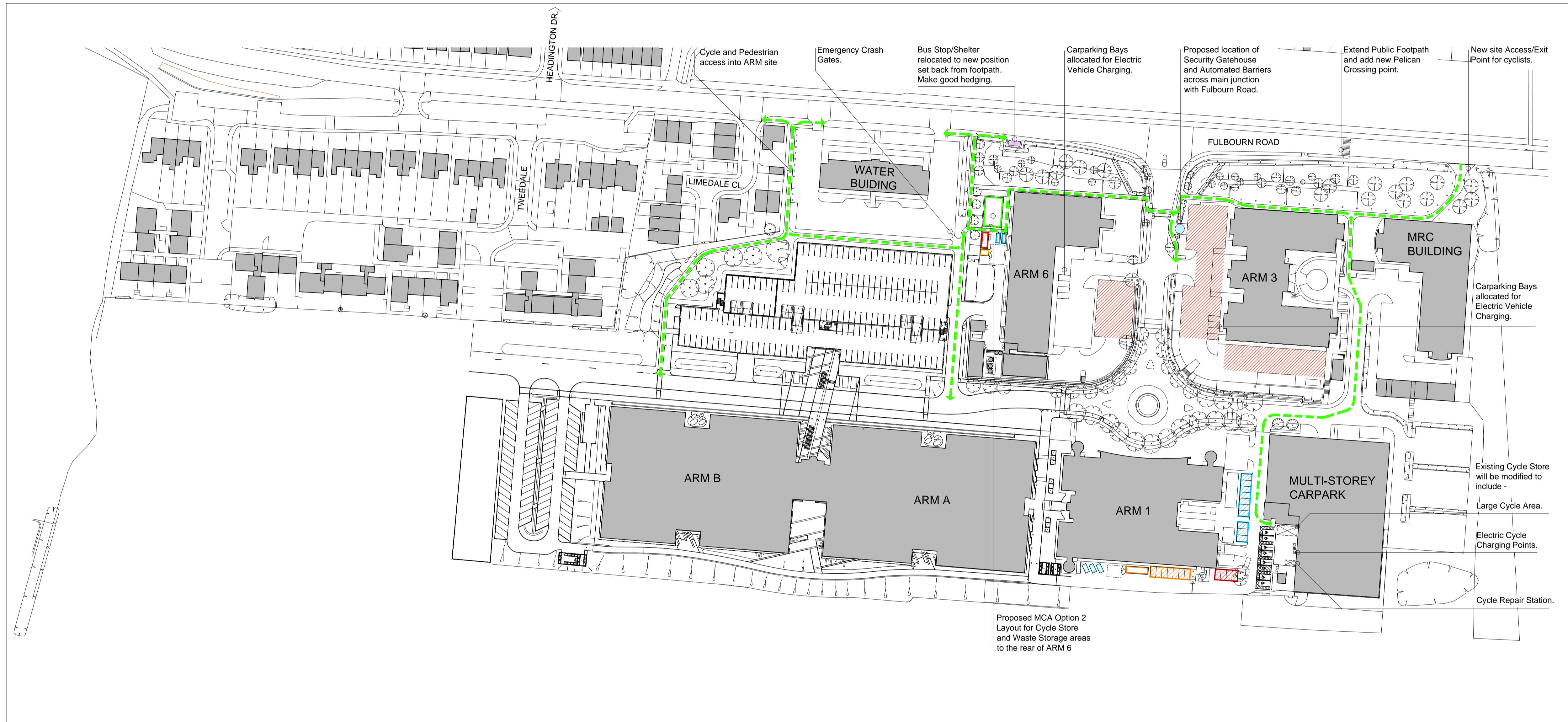

ARM Fulbourn Road Campus, Cambridge

Site Layout Plan: Parking and Storage Zones As Proposed

B	07.08.17	Cycle route modified	IDW
A	07.08.17	Design development	IDW
rev	date	description	drawn

client:
ARM

project name:
Fulbourn Road Campus
Cambridge

drawing name:
Site Layout Plan Option:
Parking & Storage Zones
As Proposed

scale (size): 1:1000@A1
drawn / approved: IDW -
date: Aug 2017

project no: 17004
drawing no: (90)06
revision: B

drawing status:
PRELIMINARY

